



**KENSINGTON**<sup>®</sup>  
Finest Properties International

# Amazingly renovated penthouse with sea view



## general:

---

<b>object number external:</b>	KAO992	<b>as from:</b>	05.03.2025
<b>usage:</b>	habitation	<b>marketing method:</b>	purchase
<b>property:</b>	flat	<b>construction year:</b>	2001
<b>place:</b>	07157 Port Andratx	<b>living space:</b>	174,00 m <sup>2</sup>
<b>Floor space:</b>	202,00 m <sup>2</sup>	<b>Number of Rooms:</b>	3,0
<b>Number of bedrooms:</b>	2,0	<b>Number of bathrooms:</b>	2,0
<b>Number of sep. bathrooms:</b>	1,0	<b>number of parking spaces:</b>	2,0
<b>Condition:</b>	part / full renovated		

## prices:

---

<b>parking garage:</b>	0,00 €	<b>purchase price:</b>	2.950.000,00 €
------------------------	--------	------------------------	----------------

## energy certificate:

---

<b>beaconing:</b>	electric
-------------------	----------

## contact person:

---

<b>name:</b>	KENSINGTON Port Andratx	<b>street:</b>	Carrer d'Antoni Calafat Toni Pino 7
<b>place:</b>	07157 Port Andratx	<b>phone:</b>	+34 971690421
<b>Email:</b>	agnes.gyulai@kensington-international.com		

## Infrastructure:

---

## Description:

---

This exquisite, fully renovated penthouse offers breathtaking panoramic views of the sea, harbor, and Dragon Island. Designed for effortless luxury, the single-level layout features barrier-free access and floor-to-ceiling windows that frame year-round sunsets.

A private 45m<sup>2</sup> rooftop terrace and direct access to the community pool create an unparalleled indoor-outdoor lifestyle. The gourmet Leicht kitchen boasts Gaggenau & Miele appliances, while bespoke built-ins, underfloor heating, and a high-end osmosis & decalcification system ensure ultimate comfort.

Two spa-inspired en suite bathrooms feature steam showers, enhanced by designer lighting from Bocci and Occio. A climate-controlled bodega, guest bath, utility room, and private double garage with direct access add convenience. Enjoy two communal pools, a Jacuzzi, and a barbecue area. Offered fully furnished, this is coastal luxury at its finest.

## images

---









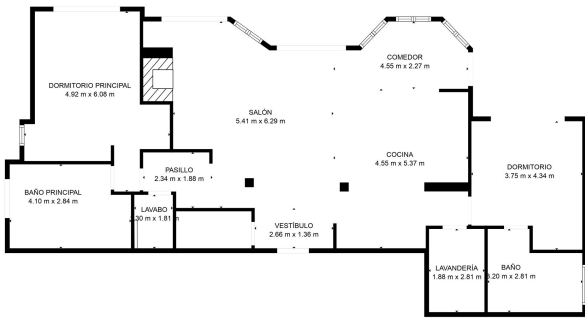

TOTAL: 140 m<sup>2</sup>  
1. PLANTA: 140 m<sup>2</sup>

LOS MEDIDOS SON CALCULADOS UTILIZANDO EL SIGUIENTE CONVENIO: 100 CM SON 1000 MM. PARA DATOS MÁS DE COMPLEMENTACIÓN.