



**KENSINGTON**<sup>®</sup>

Finest Properties International



## general:

---

<b>object number external:</b>	Kensington_KBP_510	<b>as from:</b>	14.02.2025
<b>usage:</b>	business	<b>marketing method:</b>	rent/lease
<b>property:</b>	retail trade (commercial property)	<b>construction year:</b>	1913
<b>street:</b>	Ahlbecker Straße 15	<b>place:</b>	10437 Berlin
<b>Floor space:</b>	21,00 m <sup>2</sup>	<b>Store space:</b>	21,00 m <sup>2</sup>
<b>Sales space:</b>	21,00 m <sup>2</sup>	<b>Number of Rooms:</b>	1,0
<b>Condition:</b>	groomed		

## prices:

---

<b>rent, utilities included:</b>	700,00 €	<b>rent per m<sup>2</sup>:</b>	30,95 €
<b>bail:</b>	2.100,00 €	<b>broker's fee:</b>	2,38 Nettokaltmieten (inkl. gesetzl. MwSt.)

## energy certificate:

---

<b>type of energy ID:</b>	VERBRAUCH	<b>expiry date:</b>	2030-05-05
<b>age group:</b>	2014	<b>heating YOC:</b>	1913
<b>value class:</b>	E	<b>primary energy sources:</b>	GAS
<b>energy consumption value:</b>	132.00 kWh/m <sup>2</sup> /a		

## contact person:

---

<b>name:</b>	Sophie Kolander	<b>street:</b>	Prenzlauer Chaussee 135
<b>place:</b>	16348 Wandlitz	<b>phone:</b>	+49 176 859 088 22
<b>Email:</b>	sophie.kolander@kensington-international.com		

## Infrastructure:

---

# images

Aktuelle Ansicht



Grundriss

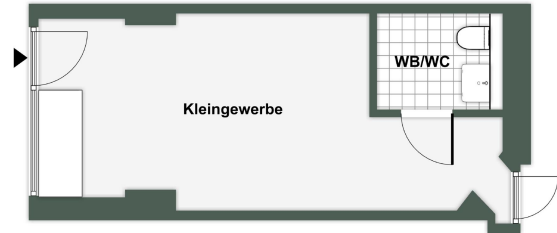

Gewerbe



**KENSINGTON**  
Finest Properties International